

# CCW-72

## Guide to operation

### ■ How to use the CCW-72

The CCW-72 is designed to protect fusion splicers.  
Always store and transport the machine in its case.

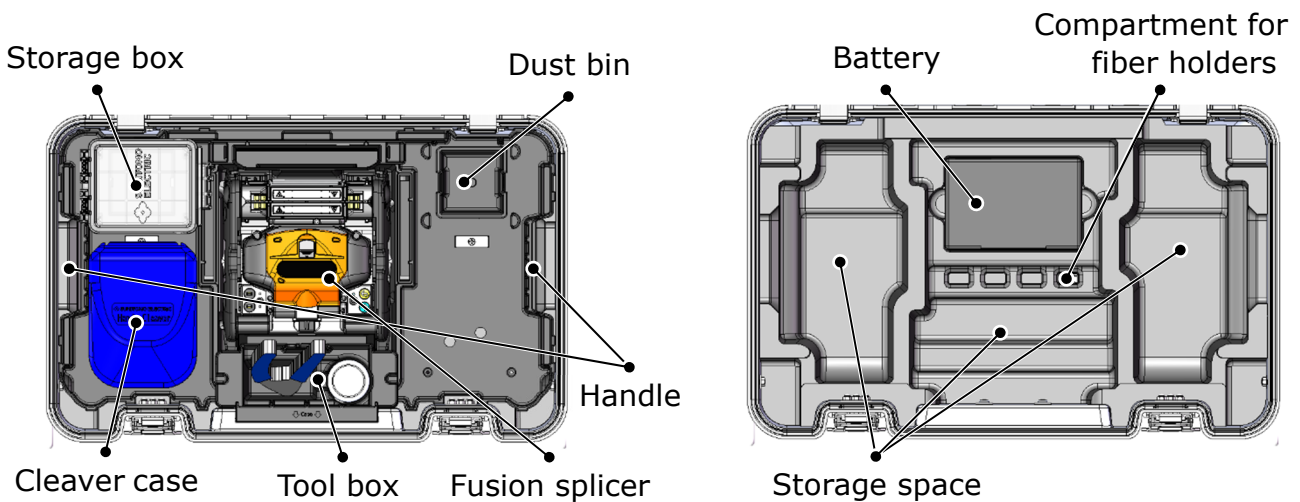

【Upper】

【Lower】



Caution

- If you carry the case while fiber scraps are in the dust bin, they may fall into the case, causing risk of injury. Empty the bin before closing the case for transport.
- Place your tools on an appropriate location on the tray before closing the case. Failure to do so can damage the inner foam.
- Do not apply excessive force to the lid of the case or carry the case by the handle or shoulder belt while the case is open. Items may fall out of the case, causing splicer to malfunction or personal injury.
- Hold the tray handle when storing the tray in the case, to avoid trapping your fingers.
- Transport the CCW-72 with the tool box in front of the splicer. Failure to do so may damage the splicer.
- Remove the tool box before removing the fusion splicer.

# How to use the WT-72

The figures below show examples of tool placement on the tray (WT-72).

WT-72 out of CCW-72 case

\*Sold separately

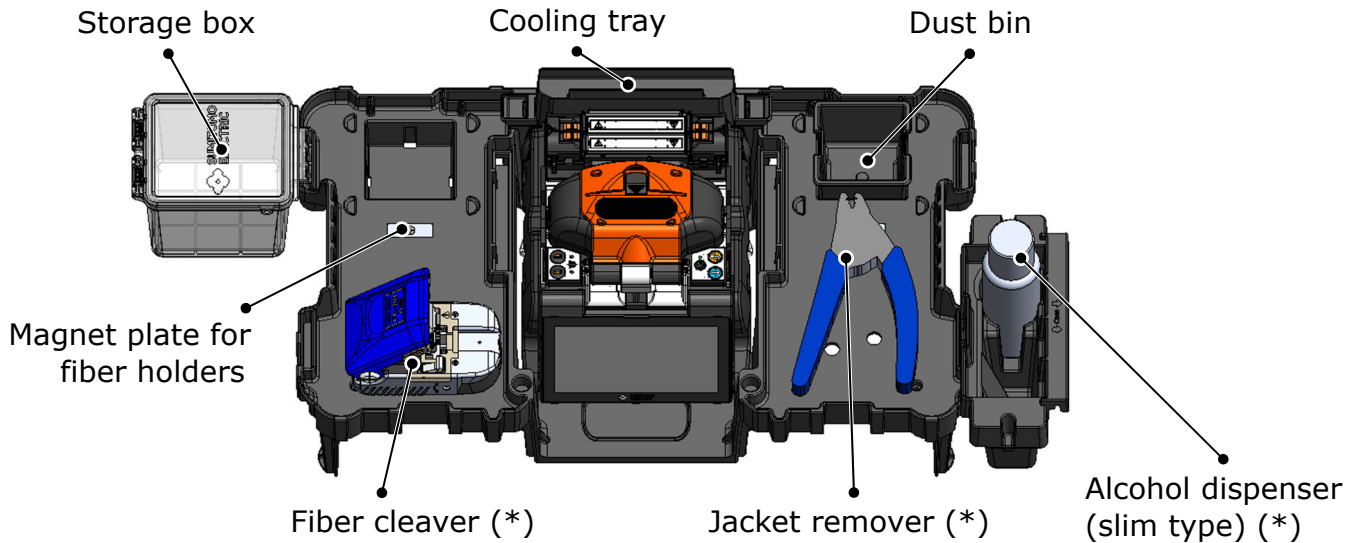

WT-72 in CCW-72 case

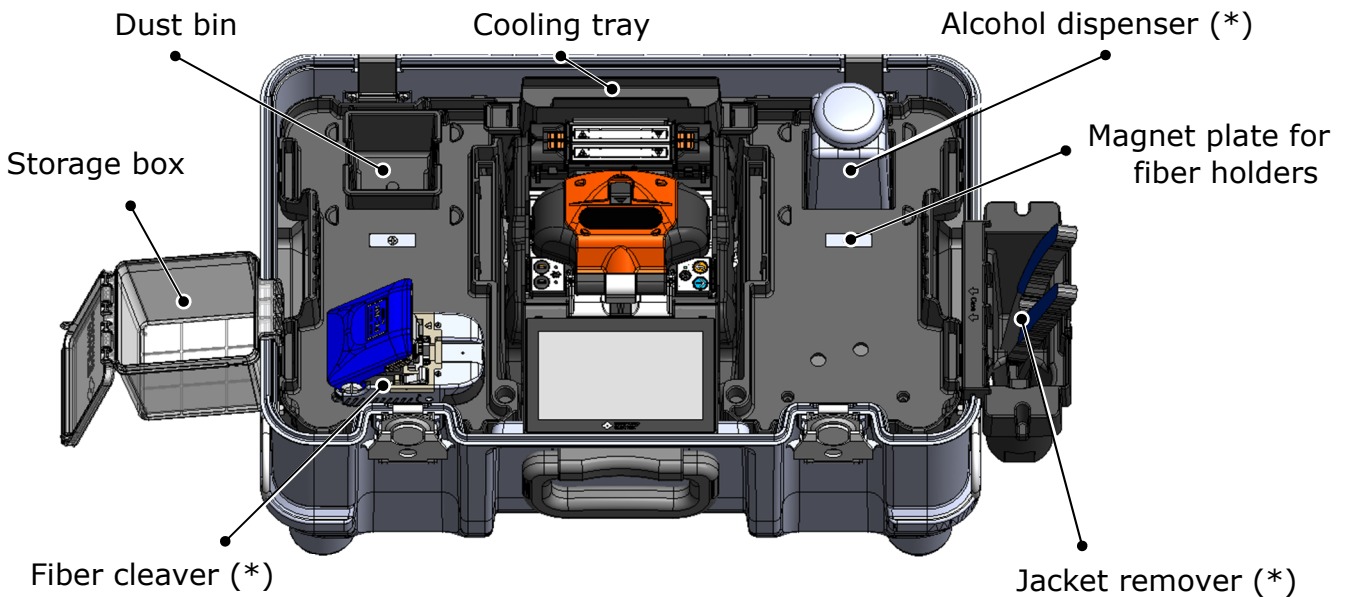

Caution

- Do not place more than 3kg (6.6lb) total on the tray.
- Do not apply excessive force to the storage box or the tool box by pushing or pulling it while it is hooked to the CCW-72.
- Lower the monitor of the fusion splicer completely and store the tool box before transporting.
- Do not open the lid of the storage box beyond the limit. It may damage its hinge.
- Do not close the case while the storage box or the tool box are hooked to the CCW-72.
- The tray may be broken by strong impact. Handle with care.

# How to use the storage box and the tool box

When storing, fit the convex part of the boxes to the concave part of the tray.

Storage box

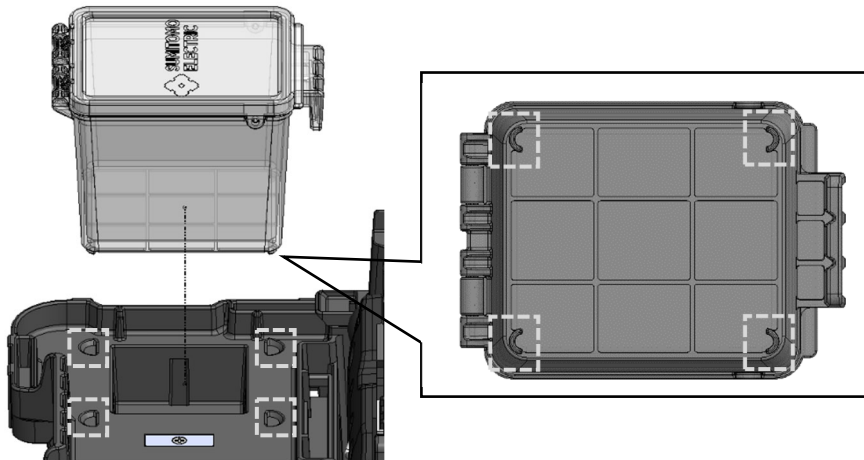

Tool box

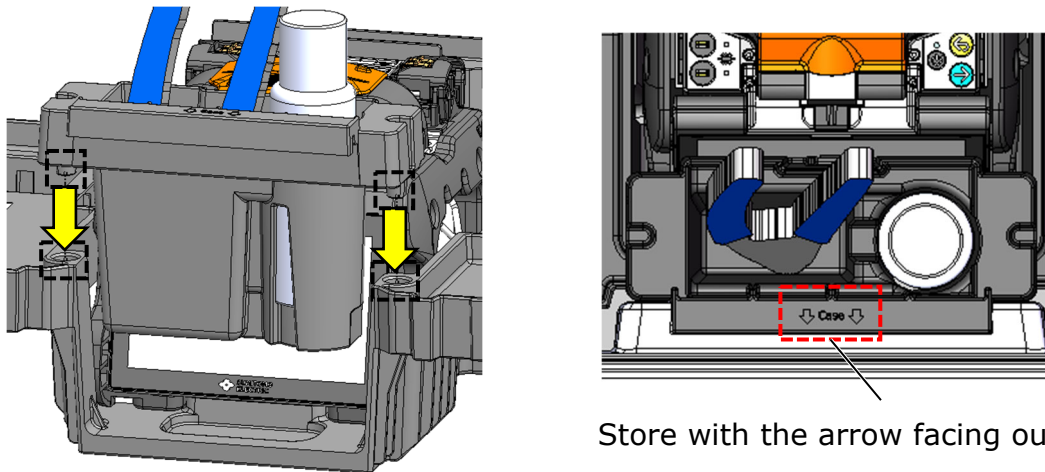

The storage box and the tool box can be hooked to the WT-72 and CCW-72.

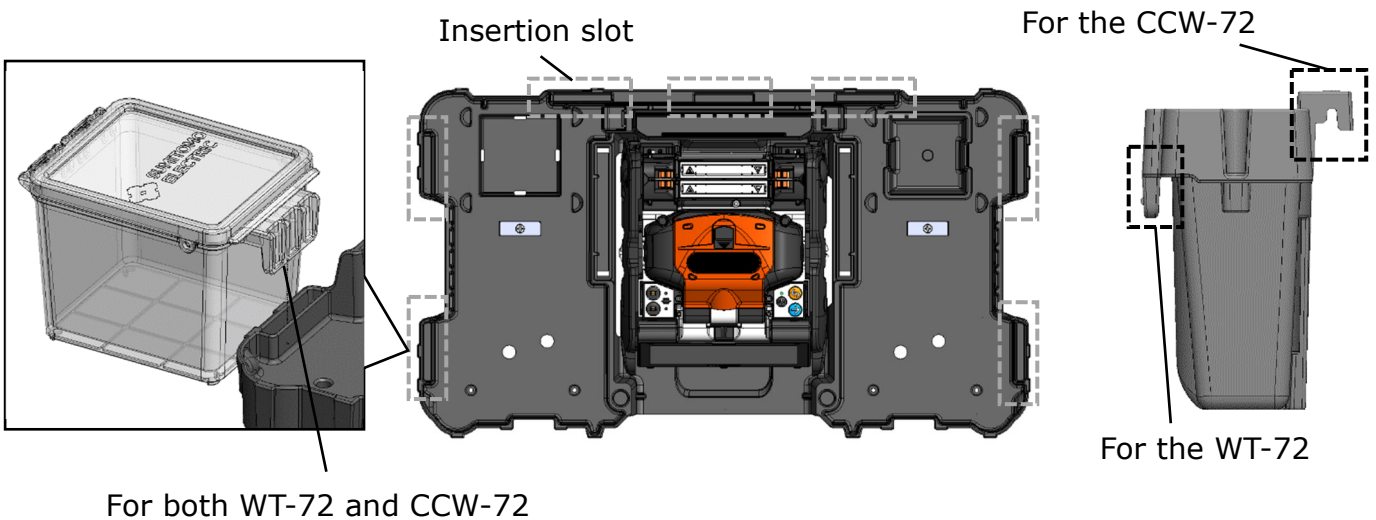

# How to secure the fiber cleaver

Place the FC-6 cleaver as shown below. Pass the supplied M6x10 Truss head machine screw through the hole of the WT-72, insert it into the screw hole [M] of the bottom of the cleaver. Tighten the screw with a screwdriver.

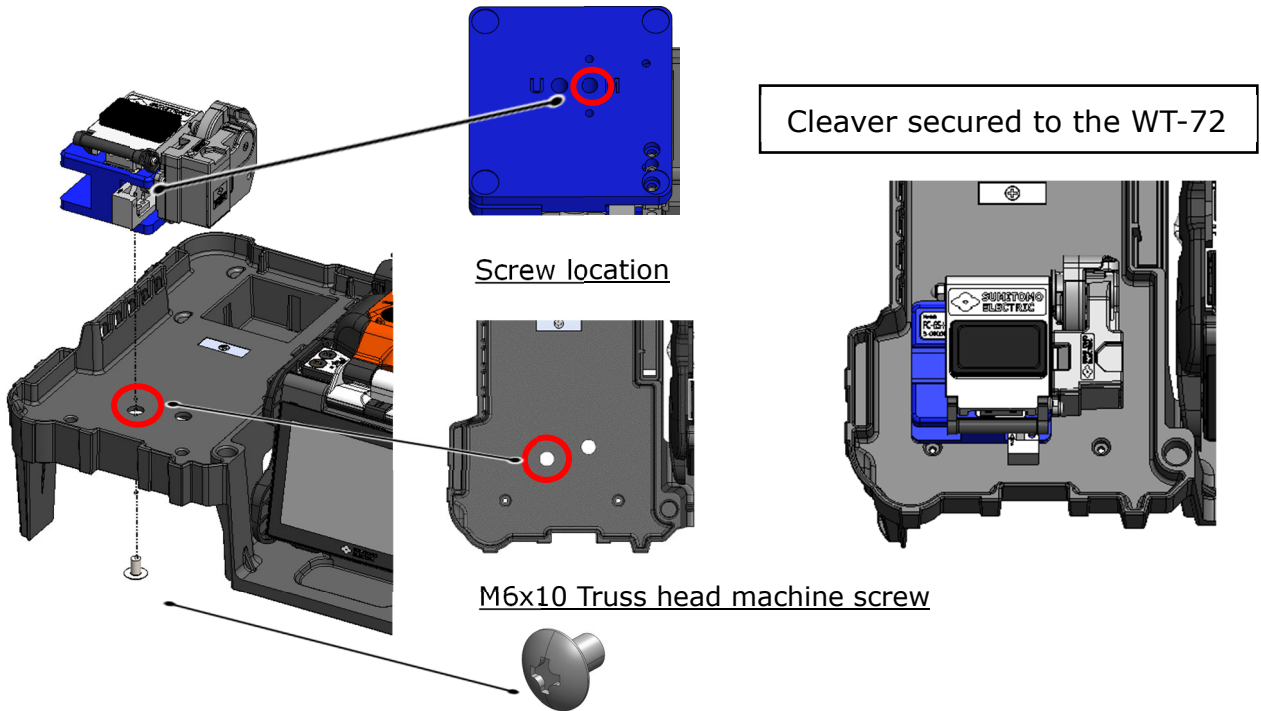

The cleaver can be secured to the right or left side of the WT-72. It can be set facing either the front or back of the case.

	Cleaver orientation	Left	Right
Facing front of case			
Facing back of case			



Caution

- Before fitting the cleaver to the WT-72, empty the off-cut collector to prevent fiber off-cuts falling out.
- When fitting the cleaver to the WT-72, ensure the screw is fully tightened to secure the cleaver.

## ■ How to place the crimp tool

The crimp tool can be placed in three locations as shown below.

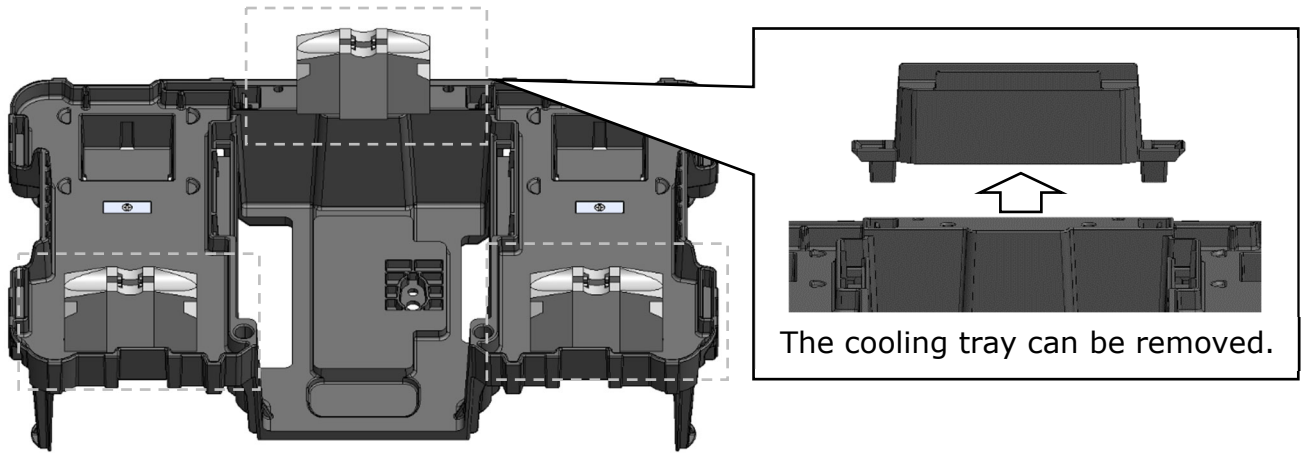

Insert the crimp tool shafts (×2) into the WT-72 and place the tool on the shafts.

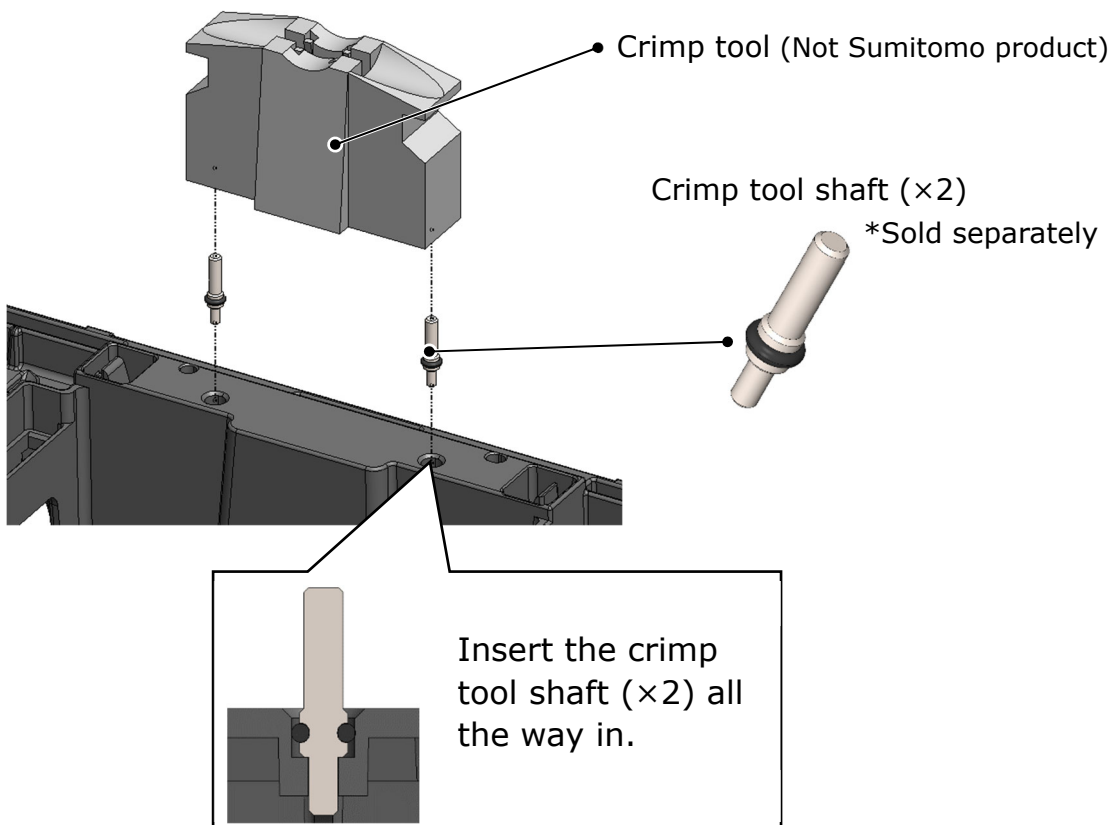

Caution

- Check beforehand if your crimp tool is compatible with WT-72. Some crimp tools may not be compatible.
- Be careful not to injure your fingers when inserting the crimp tool shaft.



## Other convenient functions

- The fusion splicer can be fixed to the WT-72. Screw holes are available for tripod mounting.

\*Sold separately

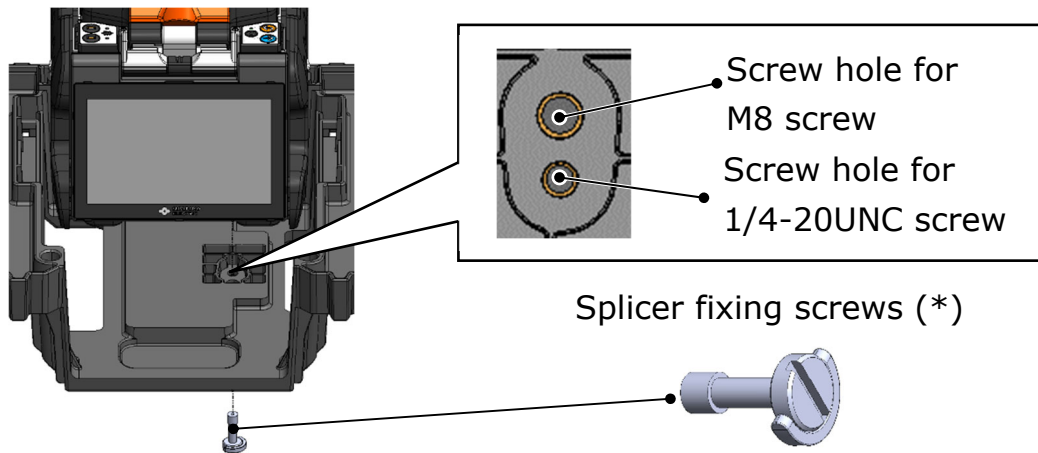

- A transfer tool is available with transfer tool stand (×2) (\*).

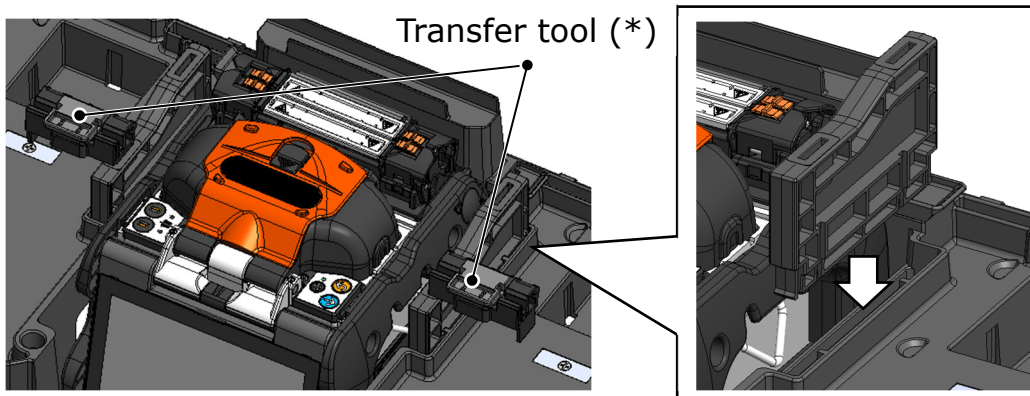

- Other functions

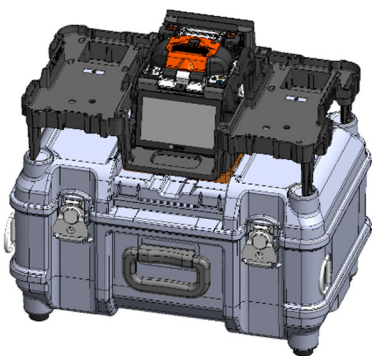

On carrying case



Tripod (Not Sumitomo product)

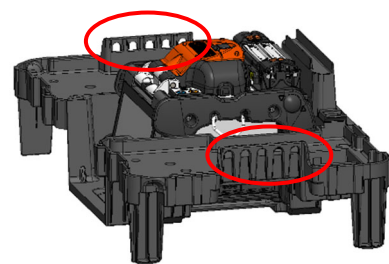

Neck strap (\*)



- Check the maximum load capacity of your tripod before mounting the WT-72 and splicer onto it.
- When working in a high location or using a neck strap, secure the fusion splicer and tools properly, and do not hook on the storage boxes.
- When using the tray with a neck strap, avoid prolonged use to avoid neck injury.