



Optical Fiber Cleaver

FC-6R

Operation Manual Supplement

Notice on Sumitomo genuine products



Caution

Please be very cautious of copy products that pretend Sumitomo genuine products.

The security hologram is a key to identifying Sumitomo genuine products.

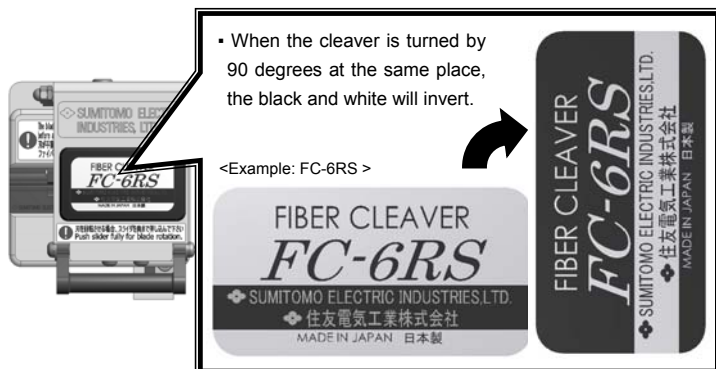

Blade Replacement

This product has been designed and manufactured to assure personal safety. Improper use can result in bodily injury and serious damage to the fiber cleaver. Please read and observe all warnings instructions given in this operation manual.



Caution

We recommend that the FC-6R should be returned to our service department for blade replacement or any repairs.



Caution

Only use a genuine Sumitomo replacement blade. We cannot guarantee the quality and performance of the FC-6R to which a non-Sumitomo replacement blade is fitted. And the use of a non-Sumitomo blade can cause serious damage to the cleaver and personal injury.



Caution

The FC-6R is a precision tool. Do not get the blade chipped by hitting a screwdriver, etc. Doing so may result in loss of cleaving performance.

1. Structure

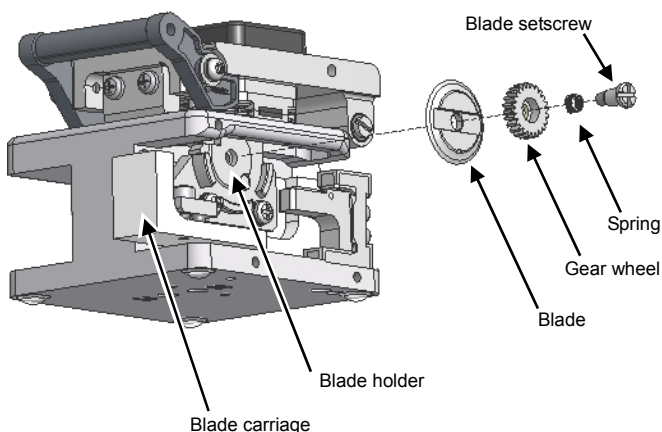

2. Blade replacement

1: For the FC-6RS(M)-C, remove the off-cut collector first referring to the FC-6R Operation Manual - "5. Fiber off-cut collector" on page 4.

2: Using "Automatic rotation", rotate the blade so that the slotted part of the blade is perpendicular to the cleaver. (Refer to the FC-6R Operation Manual - "3. Operating procedures: Switching of blade rotating operations".)

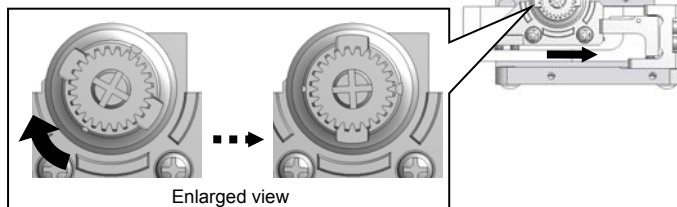

3: Slide the blade carriage in the forward direction.

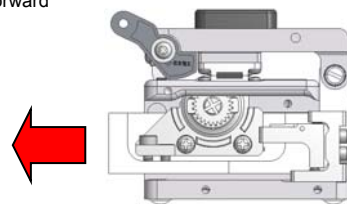

4: Lay the cleaver on its side. Remove the blade setscrew and spring.

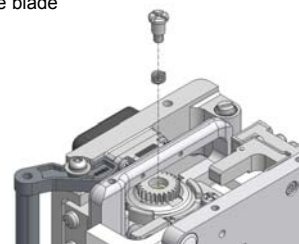

5: Remove the gear wheel and blade.

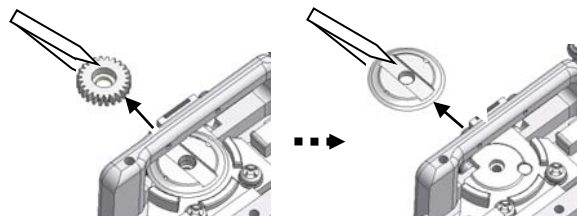

Caution

- The edge of the blade is manufactured precisely. If the edge is hit against metallic objects, it will crack, resulting in poor cleaving performance. Handle with care.
- When using metallic tweezers, be careful not to damage the blade.
- Do not touch the blade with hands. Use gloves.
- Dispose of the old blade properly.

6: Gently insert a new blade in the cleaver, making its slotted part parallel to the insertion direction. Align the hole of the blade with the hole of the blade holding surface.

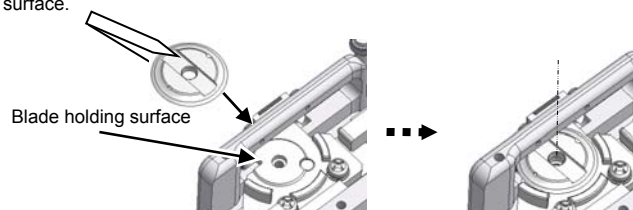

- 7: Re-insert the gear wheel back in the cleaver following the slotted part of the blade. Align the hole of the gear wheel with the hole of the blade.



Tips

Fit the convex part of the gear wheel into the slotted part of the blade. Keep the blade stable by holding the blade lightly, and then slide the gear wheel.

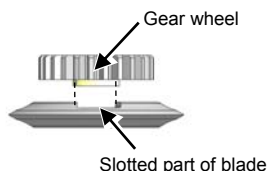

Caution

If the blade is not stable and moves, the edge of the blade will hit against the protruding part of the blade holder, causing the edge to get chipped, which leads to loss of cleaving performance.

- 8: Place the spring in the hole of the gear wheel. While holding the top surface of the gear wheel lightly with your fingers, put in the blade setscrew and tighten it firmly.

[Reference] Optimum torque: Approx. 0.98N·m (10kgf·cm)

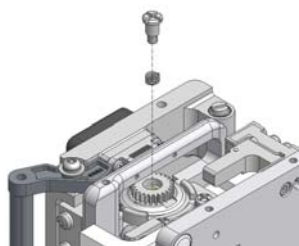

- 9: With "R Automatic rotation", slide the blade carriage to the rear of the cleaver. Ensure that the new blade is rotated 360 degrees in 24 steps.

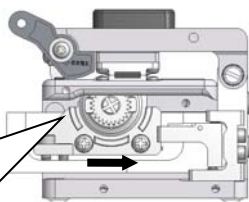
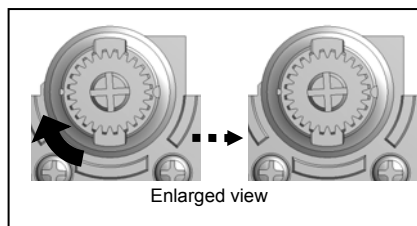

Caution

If the new blade is not rotated properly, please contact our service department.

Tokyo (JAPAN)
Sumitomo Electric Industries, Ltd.
 (Global Business Dept.)
 Akasaka Center Building, 1-3-13,
 Motoakasaka, Minato-ku, Tokyo
 107-8468, JAPAN
 Tel: +81 (0)3 6406 2666
<http://global-sei.com/sumitomo-electric-splicers>

North Carolina (U.S.A.)
Sumitomo Electric Lightwave Corp.
 201 South Rogers Lane, Suite 100
 Raleigh, NC27610 U.S.A.
 Toll Free No. 800 358 7378
 Tel: +1 919 541 8100
<http://www.sumitomoelectric.com>

London (U.K.)
Sumitomo Electric Europe Ltd.
 220 Centennial Park, Centennial Avenue,
 Elstree, Herts, WD6 3SL, U.K.
 Tel: +44 (0)20 8953 8118
<http://www.sumielectric.com>

Hong Kong (China)
Sumitomo Electric Asia, Ltd.
 Tel: +852 2576 0080
<http://www.seac-cn.com/>

Bangkok (Thailand)
Sumitomo Electric (Thailand) Limited
 Tel: +66 (0)2 260 7231 to 5
<http://www.set-th.com/>

Singapore
Sumitomo Electric Asia Pacific Pte. Ltd.
 Tel: +65 6261 3388
<http://www.seps.com.sg/>

Dubai (U.A.E.)
Middle East office
 Tel: +971 4 701 7338

Gurgaon (India)
SEI Trading India Pvt. Ltd. (SETI)
 Tel: +91 124 4577 470

Manila (Philippines)
SEI (PHILIPPINES) INCORPORATED
 Tel: +63 2 811 2755/2756